

# s.30 DZR compression ends with extension stem full port 12 - 54 mm dezincification-resistant hot forged ball valves

Several governmental authorities recommend use of special alloys for valves handling water in areas where there is a problem of dezincification.

**RuB** DZR valves are designed to meet such requirements. Through the use of new technology these valves retain the reliability and competitiveness of brass, but are comparable to bronze in corrosion resistance.

Be kind with yourself, make sure the valve that brings you pure fresh water is an **RuB** DZR valve.

## Quality:

- 24h 100% seal test guaranteed
- Dual sealing system allows valve to be operated in either direction making installation easier
- No metal-to-metal moving parts
- Handle clearly shows ball position
- Silicone-free lubricant on all seals
- Travel stops on body to avoid stresses at stem
- Chrome plated DZR brass ball for longer life

## Body:

- Hot forged sand blasted DZR unplated body and cap sealed with Loctite® or equivalent thread sealant
- Dezincification resistant ADZ-T and ADZ-P brass approved to SBN-PFS 1983:2 and NR-BFS 1988:18 specifications
- Extended stem forged in one piece with body allows perfect sealing and easy operation when valve is isolated

## Stem:

- Two FPM O-rings at the stem for maximum safety
- Unplated DZR brass stem

## Sealing:

- Pure PTFE self-lubricating seats with flexible-lip design

## PED Directives:

- The product described in this document meets the requirements of PED Directive 2014/68/UE and according to art.4 par.3, it does not require CE marking; it cannot be used with dangerous gases in sizes larger than 25mm



## Threads:

- Compression ends to EN 1254-2 and NKB no.12

## Flow:

- Full port to DIN 3357 for maximum flow

## Handle:

- Geomet® carbon steel handle with thick PVC dip coating. Handle coating offers both thermal and electrical protection
- Handle removable with valve in service

## Working Pressure:

- 16 Bar (230 PSI) non-shock cold working pressure

## Working Temperature:

- -20°C (-4°F) / +120°C (+250°F)
- **WARNING:** freezing of the fluid in the installation may severely damage the valve

## Options:

- T-handle
- Oval lockable handle
- AISI 430 stainless steel handle
- Patented locking device
- Short stem design

## Upon Request:

- AISI 316 stainless steel ball
- Glass filled PTFE seals
- Custom design

## Approved by or in compliance with:

- Swedcert (Sweden)
- GOST-R (Russia)
- Hygiene and epidemic center in Moscow city (Russia)
- UkrSepro (Ukraine)
- RoHS Compliant (EU)
- EAC - Declaration of conformity (Russia-Kazakhstan-Belarus)

**NOTE:** Approvals apply to specific configurations/sizes only.

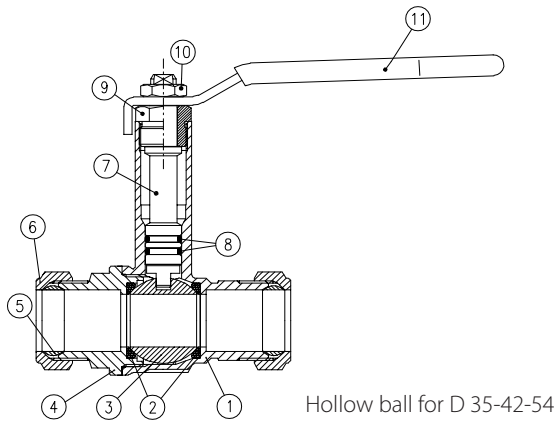

Part description	Q.ty	Material
1	1	CW602N
2	2	PTFE
3	1	CW602N
4	1	CW602N
5	2	CW617N
6	2	CW617N
7	1	CW602N
8	2	FPM
9	1	CW617N
10	1	CB4FF
11	1	DD11

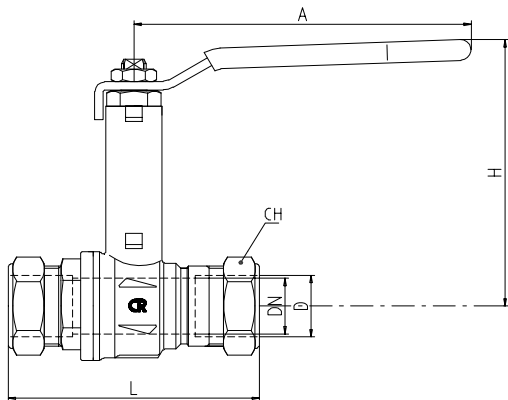

Code	S30C12	S30D15	S30D18	S30E22	S30F28	S30G35	S30H42	S30I54
D (mm)	12	15	18	22	28	35	42	54
DN (mm)	10.5	13	15	19	24	30	38	48
L (mm)	67	72	78.5	79	90.5	110	128.5	142
A (mm)	100	100	100	120	120	158	158	158
H (mm)	85	88	88	95	99	124	130	137
CH (mm)	19	24	27	32	38.5	48	54	70

DN shows the nominal flow diameter. Actual flow diameter complies with full port DIN 3357 part 4.

Ask for additional information on the whole range of **RuB** valves and consult with your supplier for special applications.

### Pressure-Temperature Chart

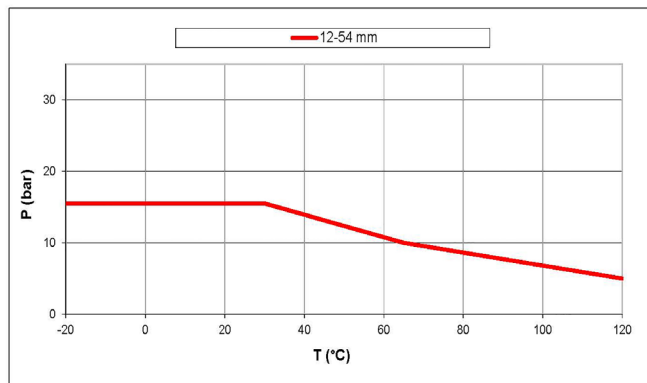

### Pressure Drop Chart

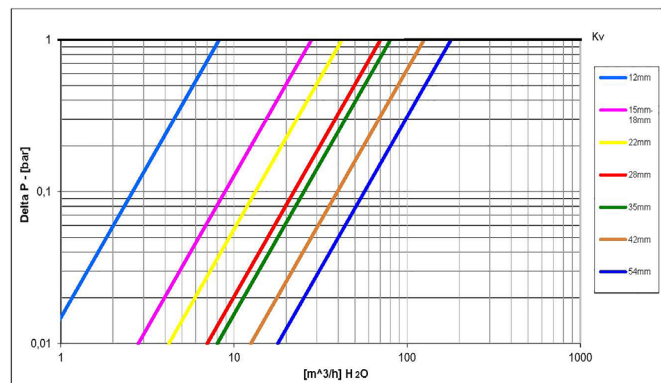

**RuB** endeavors to provide comprehensive information about the installation, maintenance and operation of its products. For more details or clarification, please contact us. **RuB** reserves the right to change or modify product design, construction, specifications, materials or the information herein without prior notice and without incurring any obligation to make such changes and modifications on **RuB** products previously or subsequently sold. Content of this document is proprietary to **RuB** and it may not be copied in part or in whole without prior written authorization from **RuB**. Recommendations on application design and material selection are based on available technical data and are offered as suggestions only. Pressure and temperature ranges are for generic use of the products. Each user should make his/her own tests to determine the suitability for his/her own particular use. **RuB** offers no express or implied warranties concerning the form, fit, or function of a product in any application. **RuB** does not accept liability for errors or omissions. Any undated reference to a code or standard shall be interpreted as referring to the latest edition. **RuB** and logo are registered trademarks of **Rubinetteria utensilerie BONOMI srl**. Other logos are property of respective owners.

XCES30 - Rev: 3728